

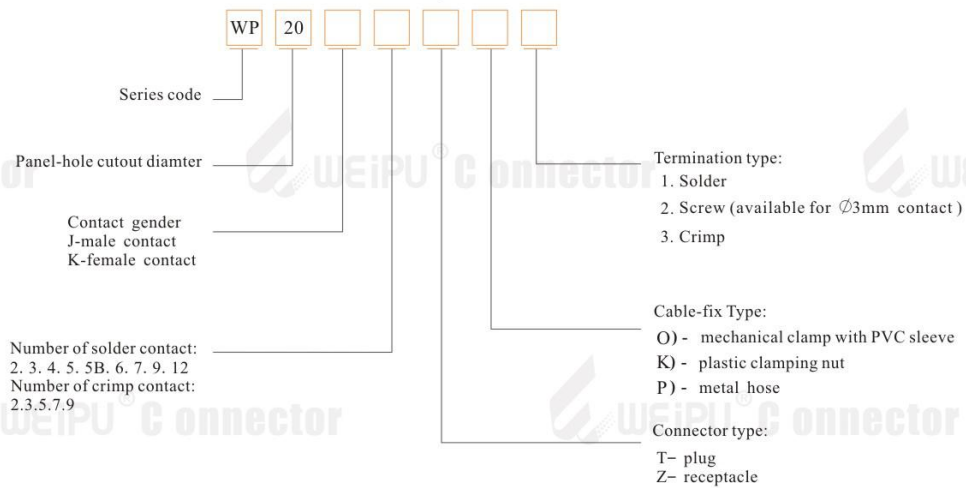

● **WP20 Series**

Part number system



The plugs and receptacles are available with male contact or female contact

Material and spec

| | |
|-------------------|---|
| Coupling | Bayonet |
| Shell | Nylon PA66 and zinc alloy |
| Insert material | PPS max temperature 260 °C , fire resistance: V-0 |
| Contact material | Brass with gold plating |
| Termination | 2-5 contacts: solder / screw , 7-12 contacts: solder, crimp |
| Mating cycle | >500 |
| Temperature range | -25°C ~ +85°C |



**WP
20**



● Receptacle: Z IP44

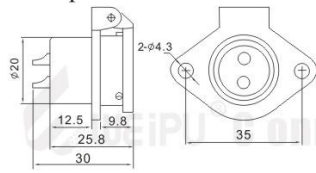

● Panel cutout

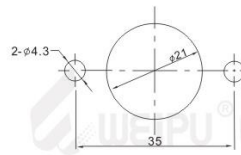

● Mechanical clamp with PVC sleeve : TO

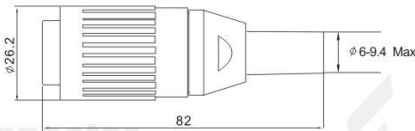

● Metal hose: TP

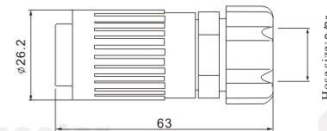

● Plastic clamping nut : TK IP55

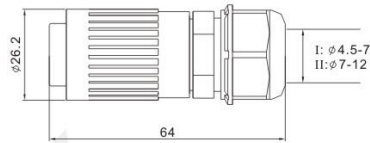

Contact arrangement and spec for solder/screw

★ For crimp spec see P49-P52

| Number of contact | 2 | 3 | 4 | 5 | 5B | 6 | 7 | 9 | 12 |
|---------------------------------|--|-----------|-----------|-----------|-------------------------|-------------------------|--------|------------|------------|
| Male contact face view | | | | | | | | | |
| Rated current(A) | 30A | 30A | 30A | 30A | 5A, 30A | 5A, 30A | 15A | 5A | 5A |
| Contact diameter | ∅ 3X2 | ∅ 3X3 | ∅ 3X4 | ∅ 3X5 | ∅ 1X3 ∅ 3X2 | ∅ 1X4 ∅ 3X2 | ∅ 2X7 | ∅ 1X9 | ∅ 1X12 |
| Rated voltage (AC.V) | 500V | 500V | 500V | 500V | 500V | 500V | 500V | 500V | 400V |
| Test voltage(AC.V) 1 min | 1500V | 1500V | 1500V | 1500V | 1500V | 1500V | 1500V | 1500V | 1200V |
| Contact resistance mΩ | 1 | 1 | 1 | 1 | 5、1 | 5、1 | 2.5 | 5 | 5 |
| Insulation resistance mΩ | 2000 | 2000 | 2000 | 2000 | 2000 | 2000 | 2000 | 2000 | 2000 |
| Termination | solder / screw solder / screw solder / screw | | | | | | solder | solder | solder |
| Wire size mm ² / AWG | ≤ 4.17/11 | ≤ 4.17/11 | ≤ 4.17/11 | ≤ 4.17/11 | ≤ 0.785/18 ≤ 4.17/11 | ≤ 0.785/18 ≤ 4.17/11 | ≤ 2/14 | ≤ 0.785/18 | ≤ 0.785/18 |