

REV NO/版次	REVISION NOTE/修订注释	DATE/日期	SIGNATURE/签名
A1	14变更为14.3±0.3 12.1±0.3变更为12.4±0.3	2020.06.13	Robin

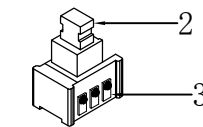
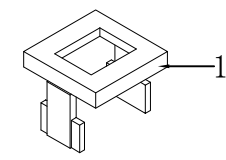
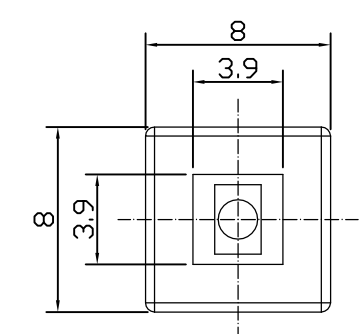

ELECTRICAL CHARACTERISTICS

1. RATING: DC 30V 0.1A
2. CONTACT RESISTANCE: 100mΩ MAX
3. INSULATION RESISTANCE: 100MΩ MIN
4. DIELECTRIC STRENGTH: AC 250V (50~60Hz) /60S

MECHANICAL CHARACTERISTICS

1. PRACTICAL TEMPERATURE RANG: -40℃~+85℃
2. OPERATING FORCE: 250±50gf
3. MECHANICAL LIFE: 30,000 cycles

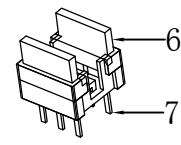
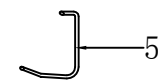
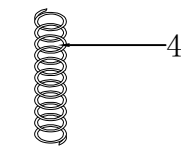
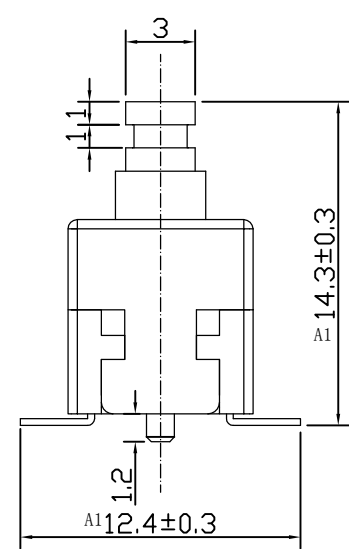
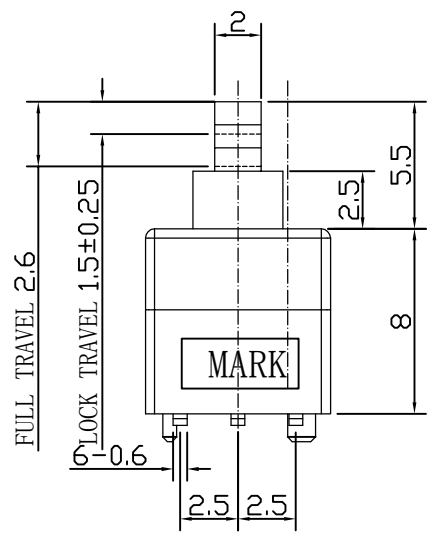

7	TERMINAL	BRASS STRIP	6	Ag PLATED
6	CASE	PPA	1	BLACK
5	LOCK PIN	SUS WIRE	1	NATURAL
4	SPRING	SUS WIRE	1	NATURAL
3	CONTACT	BRONZE	2	Ag PLATED
2	KNOB	PPA	1	WHITE
1	COVER	PPA	1	WHITE
NO.	PART NAME	MATERIAL	QTY.	FINISHING

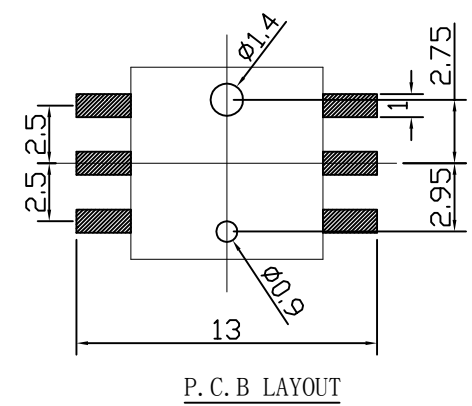
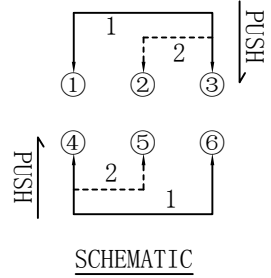
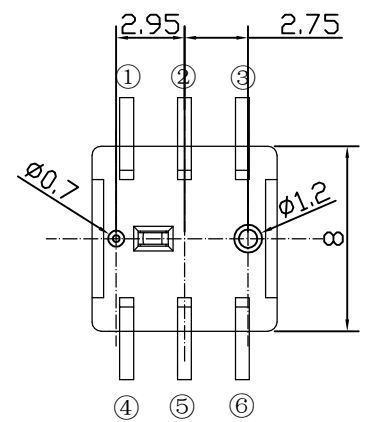

GENERAL TOLERANCE 未指的公差		TITLE 名称 PB80L250S 定位柱1.2mm			
X. ± 0.5	X. ° ± 5°	PART NO. 零件编号		DWG NO. 图纸编号	
.X ± 0.3	.X° ± 2°	DRAWN 设计		UNIT 单位 (mm)	SCALE 比例
.XX ± 0.2	.XX° ± 1°	CHECKED 核准		1:1	PROJ.
.XXX ± 0.1	.XXX° ± 0.5°			REV.	